



Jordan fishwick

Titterington Avenue
Chorlton



The Property

**** AVAILABLE NOW **** A superbly presented garden-fronted end terraced period property located on a quiet cul-de-sac close to Chorlton village. The property offers elegant and spacious accommodation with a large garden to the rear which is adjacent to local Allotments this property would ideally suit a professional couple or family. In brief: entrance hall, lounge, dining room, fitted dining kitchen. To the first floor there are three well proportioned bedrooms and a family bathroom with a white suite and over bath shower. Gas central heating and double glazing are installed throughout. Located on a highly regarded road this fine home is one not to miss, to avoid disappointment please call or email to arrange a viewing. No sharers.
***** 0161 393 7539 or email yasminemccarthy@jordanfishwick.co.uk *****

Directions

**Titterington Avenue Chorlton
M21 9QP**

£1,700 Per Calendar Month



- Available Now
- Well presented Period Terrace
- Large garden to rear
- Cul-de-sac
- 2 Reception Rooms
- 3 Bedrooms
- Council Tax Band B

Postcode - M21 9QP
EPC Rating - D
Floor Area - sq ft
Local Authority - Manchester
Council Tax - B



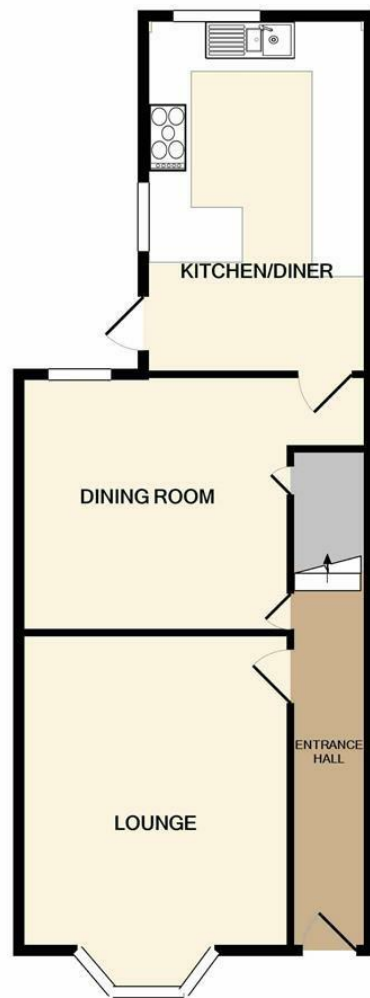

GROUND FLOOR



1ST FLOOR

Measurements are approximate. Not to scale. Illustrative purposes only
Made with Metropix ©2021



These particulars are believed to be accurate but they are not guaranteed and do not form a contract. Neither Jordan Fishwick nor the vendor or lessor accept any responsibility in respect of these particulars, which are not intended to be statements or representations of fact and any intending purchaser or lessee must satisfy himself by inspection or otherwise as to the correctness of each of the statements contained in these particulars. Any floorplans on this brochure are for illustrative purposes only and are not necessarily to scale.

Offices at: Offices at Chorlton, Didsbury, Disley, Hale, Glossop, Macclesfield, Manchester Deansgate, Manchester Whitworth Street, New Mills, Sale, Wilmslow and Withington

410-412 Barlow Moor Road, Chorlton, Manchester, M21
8AD

www.jordanfishwick.co.uk