



Jordan fishwick

Chandos Road
Chorlton



Chandos Road Chorlton M21 0SS

£1,350 Per Calendar Month



The Property

**** AVAILABLE EARLY APRIL**** SUPERB TWO DOUBLE BEDROOM APARTMENT SITUATED IN A STUNNING PERIOD PROPERTY!

A stunning development of just four x 2 double bedroom luxury apartment within a fully renovated and refurbished Edwardian house. Located only a short walk to Chorlton village and the Metrolink, on one of the most desirable roads in Chorlton - Chandos Road, which is a peaceful cul-de-sac. The apartments are ideal for professional couples or a single person. Each of the individually designed apartments is finished to the highest of standards throughout. Private entrance hallway, fitted designer kitchen/bathroom, large living/dining area. Both double bedrooms are spacious, stunning bathrooms with four piece white suite, including bath and separate walk-in shower. Each apartment has superb fitted kitchens, appliances include fridge/freezer, oven, ceramic hob, washer and dishwasher. Fully double glazed and insulated, with thermostatically controlled efficient gas central heating. Attractive landscaped south facing communal gardens and secure bike store. TV, Virgin Media points already installed.

***** To arrange a viewing please call 0161 393 7539/860 4444 *****

Directions

- Available April
- Beautifully presented two double bedroom apartment
- Completely renovated period property
- Cul-de-sac village centre location
- Well maintained communal gardens
- Unfurnished with all white goods included
- Council Tax Band A

Postcode - M21 0SS

EPC Rating - B

Floor Area - sq ft

Local Authority - Manchester

Council Tax - B



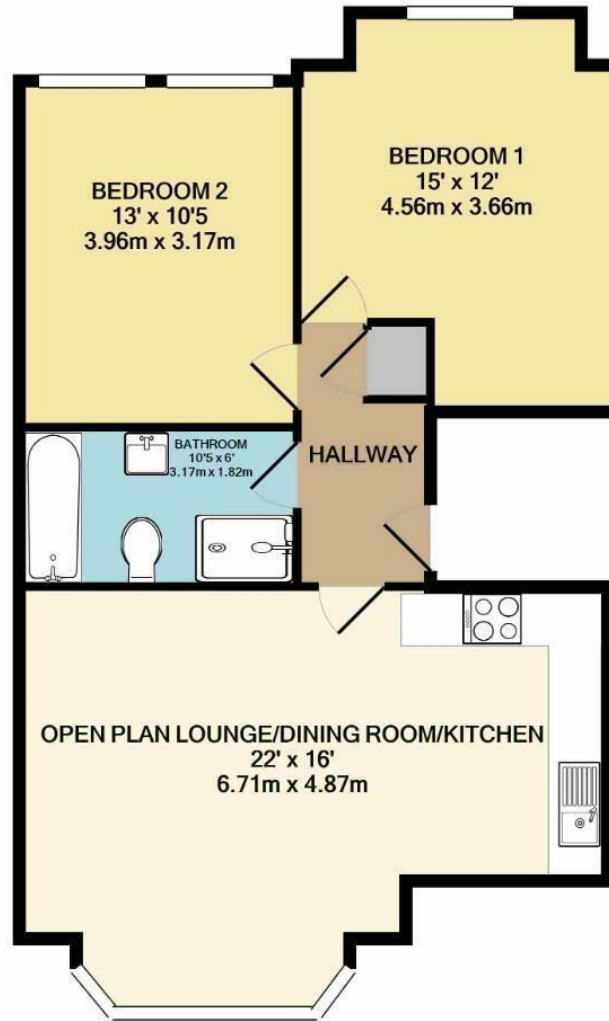

TOTAL APPROX. FLOOR AREA 703 SQ.FT. (65.3 SQ.M.)
 Measurements are approximate. Not to scale. Illustrative purposes only
 Made with Metropix ©2022



These particulars are believed to be accurate but they are not guaranteed and do not form a contract. Neither Jordan Fishwick nor the vendor or lessor accept any responsibility in respect of these particulars, which are not intended to be statements or representations of fact and any intending purchaser or lessee must satisfy himself by inspection or otherwise as to the correctness of each of the statements contained in these particulars. Any floorplans on this brochure are for illustrative purposes only and are not necessarily to scale.

Offices at: Offices at Chorlton, Didsbury, Disley, Hale, Glossop, Macclesfield, Manchester Deansgate, Manchester Whitworth Street, New Mills, Sale, Wilmslow and Withington

410-412 Barlow Moor Road, Chorlton, Manchester, M21 8AD

www.jordanfishwick.co.uk