



*Jordan fishwick*

Wood Road  
Whalley Range



## Wood Road Whalley Range M16 8BL

£1,150 Per Calendar Month



### The Property

\*\*\*AVAILABLE NOW\*\*\* Jordan Fishwick are delighted to bring to the rental market this development, set on one of Whalley Range's most prestigious tree lined roads. Finished to an excellent standard the development offers six spacious apartments of various layouts, secure communal areas, ample parking & communal gardens. Apartment One is a two double bedroom, two bathroom, lower ground floor apartment that briefly consists; entrance hall, spacious open plan lounge & kitchen with integrated appliances, private terrace, master bedroom with en-suite bathroom, second bedroom and a "Jack & Jill" shower room. Gas Central heating & security alarm are installed.

\*\*\*\*\* To arrange a viewing please call 0161 393 7539/860 4444 \*\*\*\*\*

### Directions

- Popular Development
- Spacious apartment within a Period conversion
- 2 Bedroom \* 2 Bathroom
- Secure Bike storgae
- Off road parking
- Communal garden
- Council Tax Band B

Postcode - M16 8BL

EPC Rating - C

Floor Area - sq ft

Local Authority - Manchester

Council Tax - B



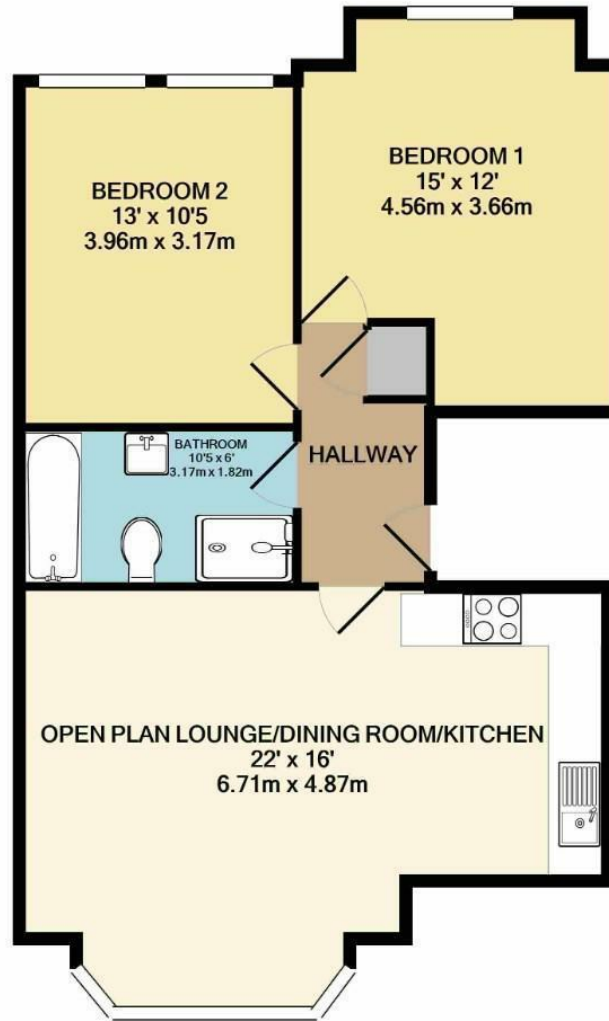

TOTAL APPROX. FLOOR AREA 703 SQ.FT. (65.3 SQ.M.)  
 Measurements are approximate. Not to scale. Illustrative purposes only  
 Made with Metropix ©2022



These particulars are believed to be accurate but they are not guaranteed and do not form a contract. Neither Jordan Fishwick nor the vendor or lessor accept any responsibility in respect of these particulars, which are not intended to be statements or representations of fact and any intending purchaser or lessee must satisfy himself by inspection or otherwise as to the correctness of each of the statements contained in these particulars. Any floorplans on this brochure are for illustrative purposes only and are not necessarily to scale.

Offices at: Offices at Chorlton, Didsbury, Disley, Hale, Glossop, Macclesfield, Manchester Deansgate, Manchester Whitworth Street, New Mills, Sale, Wilmslow and Withington

410-412 Barlow Moor Road, Chorlton, Manchester, M21  
 8AD

[www.jordanfishwick.co.uk](http://www.jordanfishwick.co.uk)