



Flat 12 Rylatt Court, Sale, M33 6WE

£220,000

www.jordanfishwick.co.uk





Jordan fishwick

- Second Floor Apartment
- In Need of Some Modernisation
- Great Location
- 150 Year Lease
- Council Tax Band B
- Two Double Bedrooms
- Garage
- No Chain
- Service Charge £2,675 PA
- EPC Rating Awaited

Spacious two double bedroom second floor apartment situated on the popular Ashton Lane within close proximity to Sale Town Centre and Ashton on Mersey Village. In need of modernisation, this apartment offers great accommodation for a variety of buyers. Briefly comprising: hall, bay fronted lounge/dining room, kitchen, two double bedrooms, bathroom and garage. UPVC windows, electric heating. NO CHAIN. Council Tax Band B. 150 Year Lease. EPC Rating Awaited.

£220,000



Lease Info & Service Charge

| | |
|----------------|--|
| Hall | 7'10" x 7'10" (2.4 x 2.4) |
| Lounge | 10'9" x 17'11" (including bay) (3.29 x 5.48 (including bay)) |
| Kitchen | 9'4" x 7'10" (2.85 x 2.39) |
| Master Bedroom | 12'9" x 10'9" (3.9 x 3.29) |
| Bedroom Two | 12'4" x 11'5" (3.76 x 3.5) |
| Bathroom | 7'10" x 7'10" (widest points) (2.41 x 2.39 (widest points)) |
| Garage | 8'0" x 16'0" (2.44 x 4.89) |





01619622828

Jordan fishwick

Why take a risk?
Sell Smarter





12

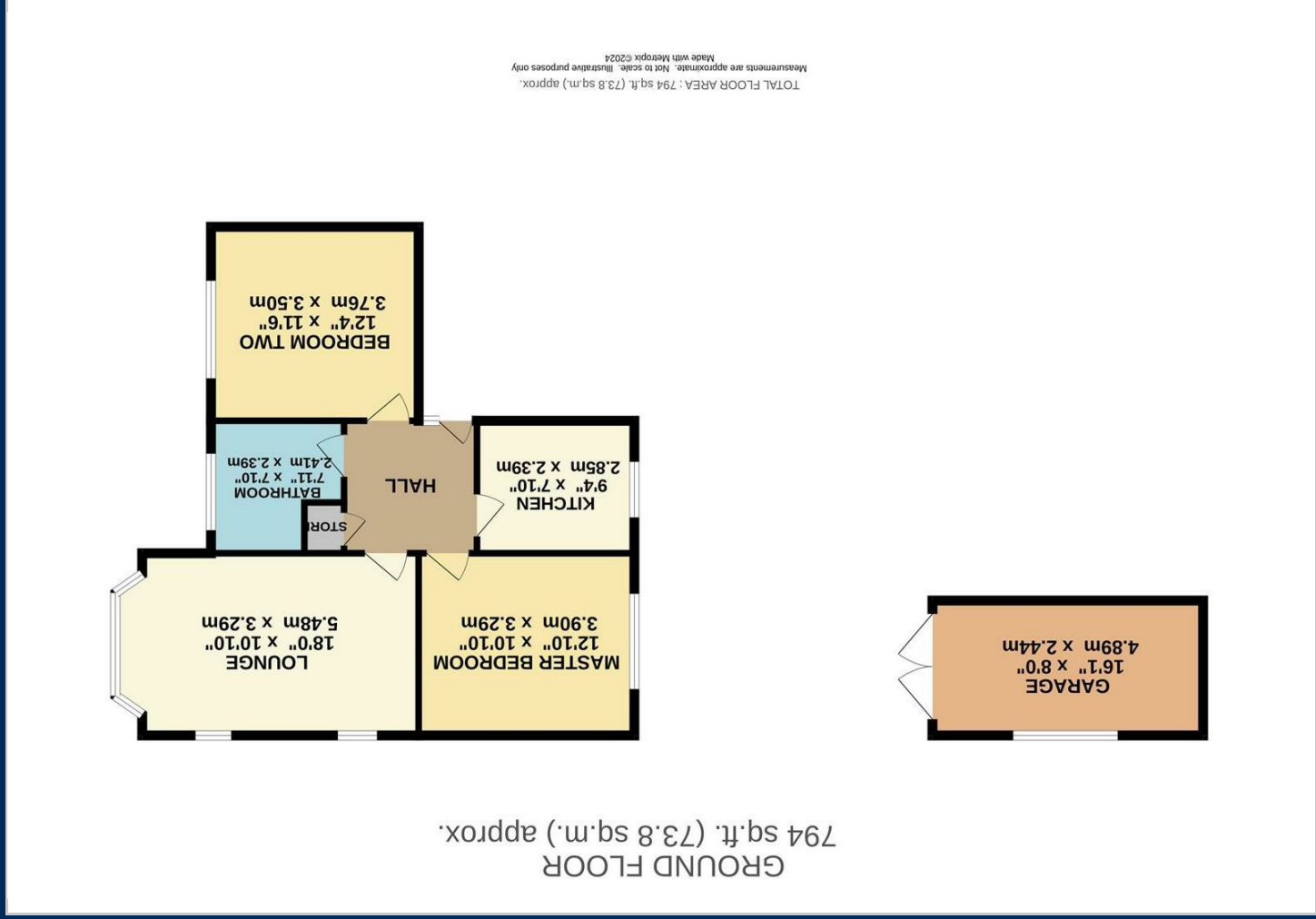

Viewing

Please contact our Sale Office on 0161 962 2828 if you wish to arrange a viewing appointment for this property or require further information.

The particulars are set out as a general outline only for the guidance of intended purchasers or lessees, and do not constitute, any part of a contract. Nothing in these particulars shall be deemed to be a statement that the property is in good structural condition or otherwise nor that any of the services, appliances, equipment or facilities are in good working order. Purchasers should satisfy themselves of this prior to purchasing.

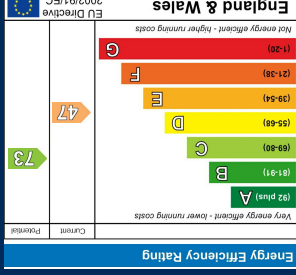

Energy Performance Graph

