



*jordan fishwick*

Buxton Road Newtown Disley Stockport



**Buxton Road Newtown Disley  
Stockport SK12 2RQ**

**Offers In The Region Of**



### The Property

Occupying an elevated position with views to both front and rear, a charming and much improved 1930's red brick bay-fronted semi-detached property. Well presented throughout with generous front garden consisting of a large driveway together with a private enclosed landscaped rear garden with useful Summer house. Stunning features including an open fire, stained glass door and picture rails complimented by a contemporary open plan ground floor, pvc double glazing and gas central heating. Comprising: entrance porch, hallway with wc, living room, open plan dining area and fitted kitchen, 18ft conservatory, three first floor bedrooms, family bathroom and second floor attic room. Viewing highly recommended.



- Elevated Position With Forward Views
- Backing Onto Farmland
- 1930's Bay Fronted Semi
- Beautiful Loft Conversion
- Open Plan Ground Floor
- Private Garden With Garden Room
- Ample Off Road Parking
- 18FT Conservatory
- Well Presented Throughout

**Postcode** SK12 2RQ

**EPC Rating** D

**Local Authority** Cheshire East

**Council Tax** D

Energy Efficiency Rating		Current	Potential
Very energy efficient - lower running costs			
(92 plus)	A		
(81-91)	B		79
(69-80)	C	65	
(55-68)	D		
(39-54)	E		
(21-38)	F		
(1-20)	G		
Not energy efficient - higher running costs			
<b>England &amp; Wales</b>		EU Directive 2002/91/EC 	



GROUND FLOOR



1ST FLOOR

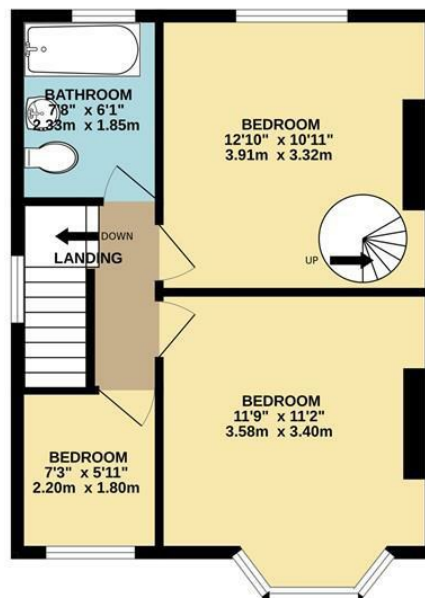

2ND FLOOR

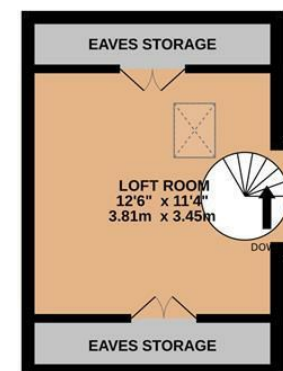

Whilst every attempt has been made to ensure the accuracy of the floorplan contained here, measurements of doors, windows, rooms and any other items are approximate and no responsibility is taken for any error, omission or mis-statement. This plan is for illustrative purposes only and should be used as such by any prospective purchaser. The services, systems and appliances shown have not been tested and no guarantee as to their operability or efficiency can be given.  
Made with Metropix ©2024



These particulars are believed to be accurate but they are not guaranteed and do not form a contract. Neither Jordan Fishwick nor the vendor or lessor accept any responsibility in respect of these particulars, which are not intended to be statements or representations of fact and any intending purchaser or lessee must satisfy himself by inspection or otherwise as to the correctness of each of the statements contained in these particulars. Any floorplans on this brochure are for illustrative purposes only and are not necessarily to scale.

Offices at: Chorlton, Didsbury, Disley, Hale, Glossop, Macclesfield, Manchester Deansgate, Manchester Whitworth Street, New Mills, Sale, Wilmslow and Withington

14 Market Street, Disley, Cheshire, SK12 2AA

01663 76 78 78

disley@jordanfishwick.co.uk

www.jordanfishwick.co.uk