



*jordan fishwick*

14 Pickmere Road, Handforth, SK9 3SR  
PCM £1,250 PCM



## Pickmere Road Cheshire SK9 3SR

£1,250 PCM



**PART FURNISHED AVAILABLE NOW - VIEWING RECOMMENDED**

Located on this popular estate offering excellent access to Manchester International Airport the A34 and within easy reach of Handforth village centre and the train station is this modern spacious three bedroom end terrace.

Having just undergone a programme of refurbishments including new carpets and full redecoration along with good sized gardens and off road parking make this property a super family home.

Entrance hall, lounge with feature fireplace, dining kitchen with ceramic hob and electric oven, washing machine and fridge freezer.

To the first floor two double bedrooms one with wardrobes and single bedroom, bathroom with shower over bath.

Off road parking and garden to front and side, enclosed rear garden with storage

Contact Wilmslow 01625 536300 £1250.00pcm



- THREE BEDROOMS
- POPULAR LOCATION
- SPACIOUS INTERIOR
- WALKING DISTANCE OF HANDFORTH VILLAGE
- ENCLOSED REAR GARDEN
- COUNCIL TAX C



Energy Efficiency Rating		
	Current	Potential
<i>Very energy efficient - lower running costs</i>		
(92 plus) <b>A</b>		
(81-91) <b>B</b>		<b>83</b>
(69-80) <b>C</b>		
(55-68) <b>D</b>	<b>64</b>	
(39-54) <b>E</b>		
(21-38) <b>F</b>		
(1-20) <b>G</b>		
<i>Not energy efficient - higher running costs</i>		
<b>England &amp; Wales</b>	EU Directive 2002/91/EC 	



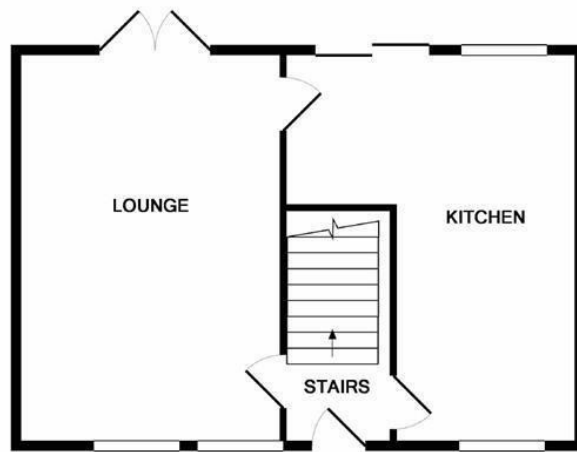

GROUND FLOOR

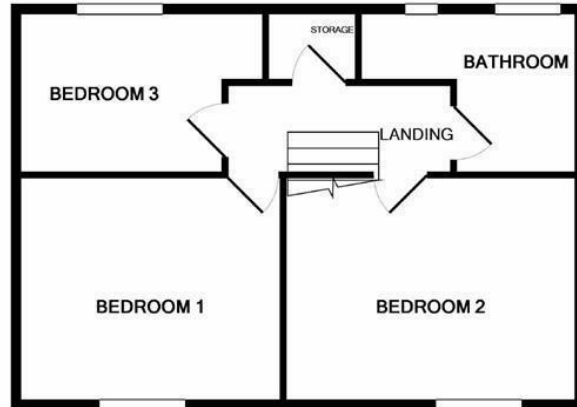

1ST FLOOR

Whilst every attempt has been made to ensure the accuracy of the floor plan contained here, measurements of doors, windows, rooms and any other items are approximate and no responsibility is taken for any error, omission, or mis-statement. This plan is for illustrative purposes only and should be used as such by any prospective purchaser. The services, systems and appliances shown have not been tested and no guarantee as to their operability or efficiency can be given  
 Made with Metropix ©2019



These particulars are believed to be accurate but they are not guaranteed and do not form a contract. Neither Jordan Fishwick nor the vendor or lessor accept any responsibility in respect of these particulars, which are not intended to be statements or representations of fact and any intending purchaser or lessee must satisfy himself by inspection or otherwise as to the correctness of each of the statements contained in these particulars. Any floorplans on this brochure are for illustrative purposes only and are not necessarily to scale.

Offices at: Chorlton, Didsbury, Disley, Hale, Glossop, Macclesfield, Manchester Deansgate, Manchester Whitworth Street, New Mills, Sale, Wilmslow and Withington

01625 536300

wilmslow@jordanfishwick.co.uk  
 www.jordanfishwick.co.uk