



Jordan fishwick

Apt 2 Prescott Court, Walkden, M28 0ZA
£775 Per Calendar Month



The Property

Available Early April. A purpose built two bedroom, ground floor apartment is located in a modern complex just outside of Worsley, Salford. Accommodation comprises of entrance hall, lounge and dining/kitchen, two double bedrooms and three piece bathroom suite. Ideally located close to a wealth of local amenities, UNFURNISHED. Parking Included. Council Tax Band A. EPC Rating D. Great for Professionals and Couples.

VIDEO/ PHOTO OFFERS NOT ACCEPTED - PLEASE CALL TO BOOK A VIEWING

Prescott Court Worsley M28 0ZA

£775 Per Calendar Month



- LET AGREED
- Two Bedrooms - Ground Floor Flat
- Un-Furnished
- Close to schools
- Close to motorway links
- Modern Bathroom
- EPC Rating D
- Council Tax Band A
- Parking included



Energy Efficiency Rating		
	Current	Potential
Very energy efficient - lower running costs		
(92 plus) A		
(81-91) B		
(69-80) C		
(55-68) D	68	77
(39-54) E		
(21-38) F		
(1-20) G		
Not energy efficient - higher running costs		
England & Wales	EU Directive 2002/91/EC 	



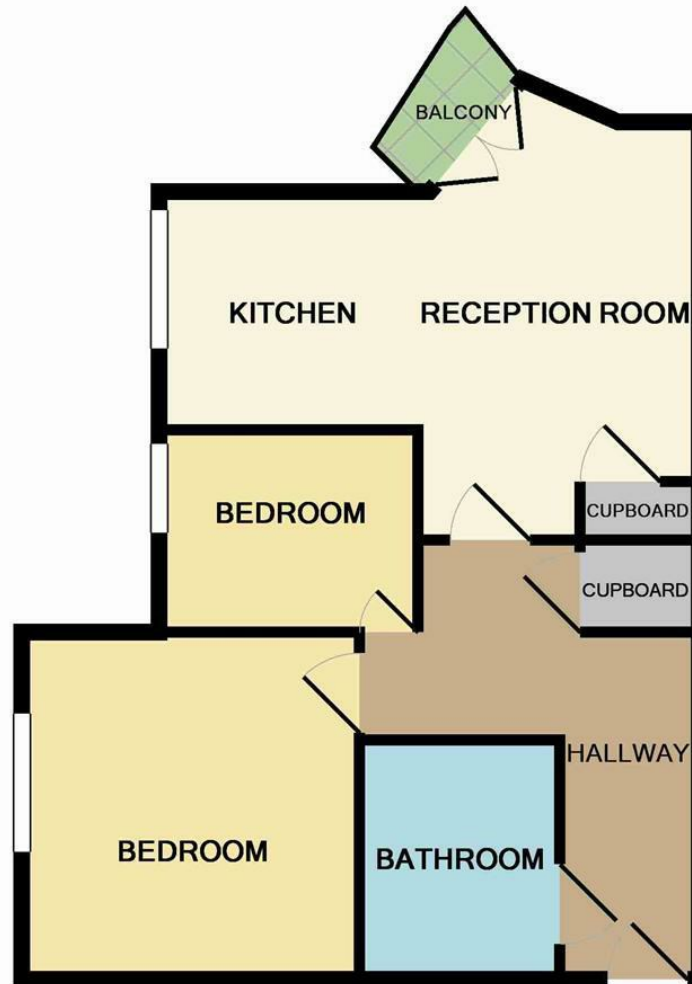

Measurements are approximate. Not to scale. Illustrative purposes only
Made with Metropix ©2013