



*jordanfishwick*

Burford Court  
Whalley Range



## Burford Court Whalley Range M16 8EA

£925 Per Calendar Month



### The Property

\*\*\*\* AVAILABLE MARCH \*\*\*\* we are delighted to offer this ground floor apartment set within a well-regarded purpose-built development offering spacious and well-presented accommodation. The property provides secure gated off-road residents car parking and attractive communal lawned gardens and comprises briefly: entrance hallway, lounge/dining room, two double bedrooms, fitted kitchen with appliances and a bathroom with a white suite and over bath shower. Double glazed windows throughout and gas heating are installed. Conveniently located for Chorlton village, local amenities and Manchester City centre.

\*\*\*\*\* To arrange a viewing please call  
0161 393 7539 /860 4444 \*\*\*\*\*

### Directions

- Available March
- 2 Double Bedroom
- Large Lounge
- Gated Development
- Off Road Parking
- Part Furnished
- Council Tax band B

Postcode - M16 8EA

EPC Rating - C

Floor Area - sq ft

Local Authority - Manchester City Council

Council Tax - B



GROUND FLOOR

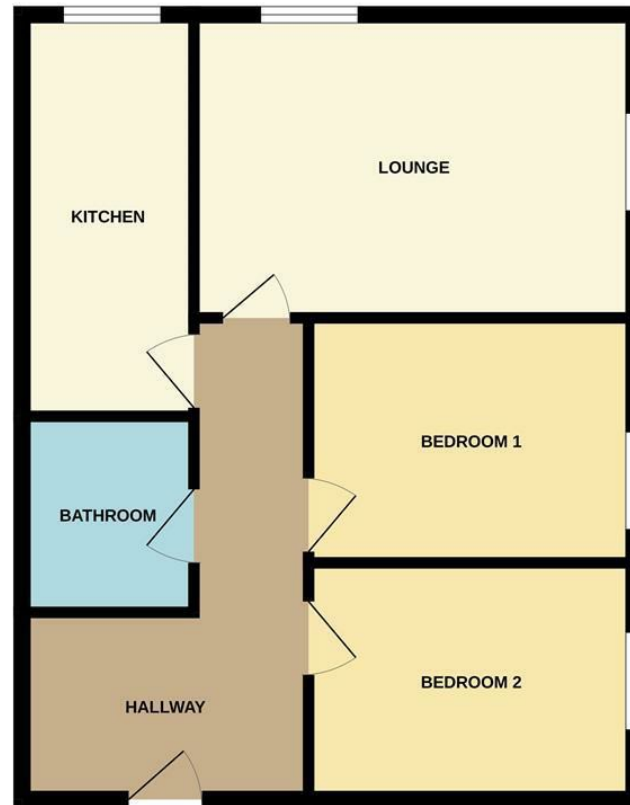

Whilst every attempt has been made to ensure the accuracy of the floorplan contained here, measurements of doors, windows, rooms and any other items are approximate and no responsibility is taken for any error, omission or mis-statement. This plan is for illustrative purposes only and should be used as such by any prospective purchaser. The services, systems and appliances shown have not been tested and no guarantee as to their operability or efficiency can be given.  
Made with Metroplan ©2024



These particulars are believed to be accurate but they are not guaranteed and do not form a contract. Neither Jordan Fishwick nor the vendor or lessor accept any responsibility in respect of these particulars, which are not intended to be statements or representations of fact and any intending purchaser or lessee must satisfy himself by inspection or otherwise as to the correctness of each of the statements contained in these particulars. Any floorplans on this brochure are for illustrative purposes only and are not necessarily to scale.

Offices at: Offices at Chorlton, Didsbury, Disley, Hale, Glossop, Macclesfield, Manchester Deansgate, Manchester Whitworth Street, New Mills, Sale, Wilmslow and Withington

410-412 Barlow Moor Road, Chorlton, Manchester, M21  
8AD

[www.jordanfishwick.co.uk](http://www.jordanfishwick.co.uk)