



*jordan fishwick*

LEVENSHULME  
Derby Grove





## Derby Grove, Levenshulme, M19 3EY

Offers Over £240,000



### The Property

A period garden fronted semi detached property offering a superb level of living space, coupled with a courtyard garden to the rear. The accommodation comprises: Large entrance hall, through lounge/dining room, re-fitted kitchen with gloss white fronted cupboards. To the first floor: master bedroom with twin windows to the front aspect, additional double bedroom with en-suite wc and a large re-fitted bathroom with white suite. Gas central heating with a newly installed combination boiler and double glazing are both fitted, The property is located only a short distance from playing fields, parks and well regarded schools, and offers excellent transport links with Stockport road and Levenshulme train station a short walk away. The property has also had a complete new roof fitted. Viewing recommended.

### Directions

M19 3EY





- Two double bed semi detached property
- Large through lounge/dining room
- Re-fitted kitchen
- Complete new roof fitted
- Newly installed combination boiler
- En-suite wc to bedroom two
- Close to all amenities & train station

**Postcode** - M19 3EY

**EPC Rating** - C

**Floor Area** - 826.00 sq ft

**Local Authority** - Manchester City Council

**Council Tax** - A



GROUND FLOOR  
428 sq.ft. (39.7 sq.m.) approx.

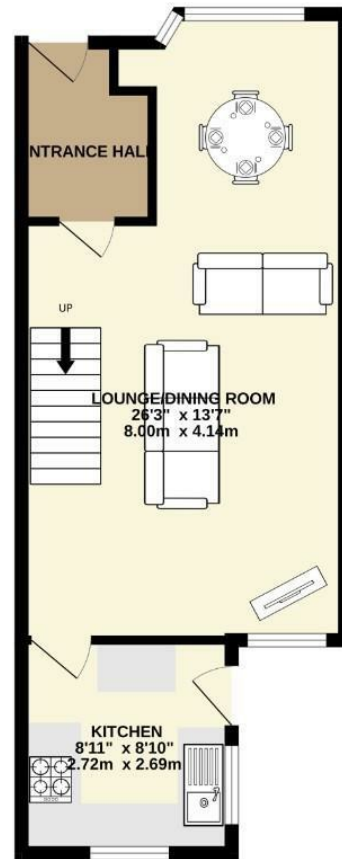

1ST FLOOR  
399 sq.ft. (37.1 sq.m.) approx.

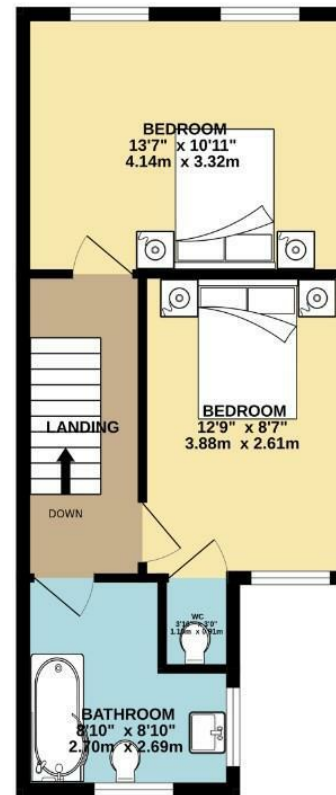

TOTAL FLOOR AREA: 826 sq.ft. (76.8 sq.m.) approx.  
Measurements are approximate. Not to scale. Illustrative purposes only.  
Made with Metropix ©2024



These particulars are believed to be accurate but they are not guaranteed and do not form a contract. Neither Jordan Fishwick nor the vendor or lessor accept any responsibility in respect of these particulars, which are not intended to be statements or representations of fact and any intending purchaser or lessee must satisfy himself by inspection or otherwise as to the correctness of each of the statements contained in these particulars. Any floorplans on this brochure are for illustrative purposes only and are not necessarily to scale.

Offices also at: Wilmslow, Macclesfield, Hale, Sale, Chorlton, Glossop, Manchester & Salford

757-759 Wilmslow Road, Didsbury Village, Manchester

0161 445 4480

didsbury@jordanfishwick.co.uk  
www.jordanfishwick.co.uk