



**jordan fishwick**

45 TIVERTON DRIVE WILMSLOW SK9 2TJ  
Guide Price £190,000

## 45 TIVERTON DRIVE WILMSLOW SK9 2TJ

TENANTED PROPERTY £900 pcm - PERFECT INVESTMENT OPPORTUNITY WITH TENANCY UNTIL JAN 2025. Rental Yield of 5.6%. Located on this extremely popular estate is this ground floor apartment. Presented in excellent condition this apartment has off road parking, two double bedrooms and is within easy reach of local shops and the A34 and is only a short drive to Wilmslow, Alderley Edge, Handforth Dean and Manchester International Airport. Entrance hall with storage, lounge diner, modern fitted kitchen, two double bedrooms and bathroom. VIEWING HIGHLY RECOMMENDED.

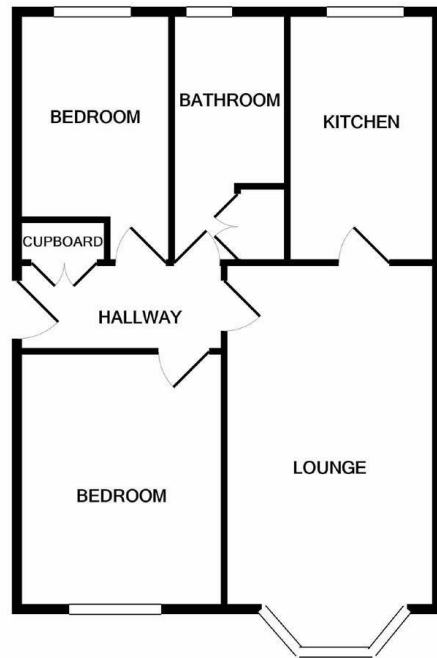

Measurements are approximate. Not to scale. Illustrative purposes only  
Made with Metropix ©2019

- POPULAR LOCATION
- GROUND FLOOR
- OFF ROAD PARKING
- EASY REACH OF LOCAL SHOPS AND AIRPORT
- TWO DOUBLE BEDROOMS
- INVESTMENT OPPORTUNITY WITH TENANT IN SITU
- EXCELLENT CONDITION
- VIEWING RECOMMENDED

