



*jordan fishwick*

6 Hawker Road, Woodford Garden Village,  
PCM £2,350 PCM





## Hawker Road Woodford SK7 1SN

£2,350 PCM



REDROW WOODFORD GARDEN VILLAGE ESTATE WOODFORD - AVAILABLE FEBRUARY PART FURNISHED Immaculately presented four bedroom detached family home on the popular Woodford Garden Village estate with its wide open spaces and beautiful homes.

Within easy reach of the A34 and only a short drive to Manchester International Airport, Wilmslow, Bramhall and Alderley Edge this spacious family home with its modern fixtures and fittings will be a popular choice for many people.

Located on a quiet road with a small children's park close by and benefiting from off road parking, sunny enclosed rear garden, garage and four double bedrooms.

Entrance hall with access to garage, good sized lounge, modern fitted kitchen with gas hob and double oven, dishwasher, fridge freezer and doors to fully enclosed sunny rear garden, utility room with washing machine and good sized storage cupboard, downstairs cloakroom.

To the first floor master bedroom with en suite shower room and fitted wardrobes, second double bedroom with fitted wardrobes, two further double bedrooms, family bathroom with shower over bath. VIEWING ESSENTIAL TO APPRECIATE Contact Wilmslow 01625 536300 £2350pcm

EPC B

COUNCIL TAX E





- FOUR BEDROOMS
- POPULAR LOCATION
- GARAGE
- GOOD SIZED SUNNY GARDEN
- COUNCIL TAX F



Energy Efficiency Rating		
	Current	Potential
Very energy efficient - lower running costs		
(92 plus) <b>A</b>		<b>94</b>
(81-91) <b>B</b>	<b>84</b>	
(69-80) <b>C</b>		
(55-68) <b>D</b>		
(39-54) <b>E</b>		
(21-38) <b>F</b>		
(1-20) <b>G</b>		
Not energy efficient - higher running costs		
<b>England &amp; Wales</b>	EU Directive 2002/91/EC 	



GROUND FLOOR

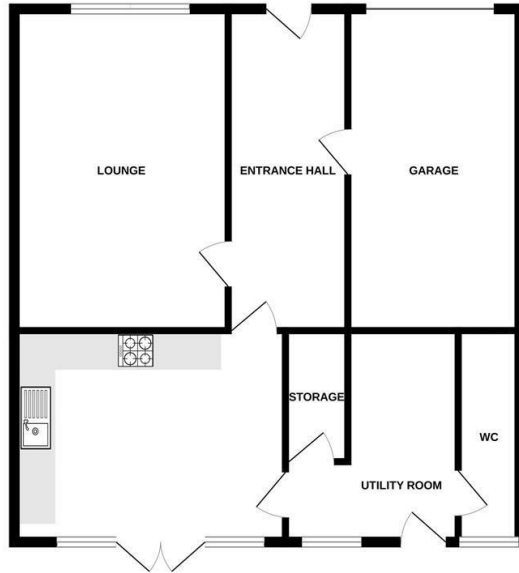

1ST FLOOR

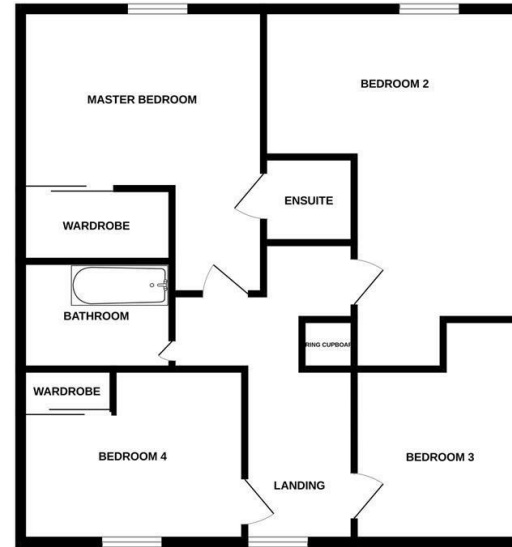

Measurements are approximate. Not to scale. Illustrative purposes only.  
Made with Metropix ©2024



These particulars are believed to be accurate but they are not guaranteed and do not form a contract. Neither Jordan Fishwick nor the vendor or lessor accept any responsibility in respect of these particulars, which are not intended to be statements or representations of fact and any intending purchaser or lessee must satisfy himself by inspection or otherwise as to the correctness of each of the statements contained in these particulars. Any floorplans on this brochure are for illustrative purposes only and are not necessarily to scale.

Offices at: Chorlton, Didsbury, Disley, Hale, Glossop, Macclesfield, Manchester Deansgate, Manchester Whitworth Street, New Mills, Sale, Wilmslow and Withington

01625 536300

wilmslow@jordanfishwick.co.uk  
www.jordanfishwick.co.uk