



Flat 4 Selbourne Lodge, Sale, M33 3DN

Offers Over £160,000

www.jordanfishwick.co.uk





Jordan fishwick

- One Bedroom Ground Floor Flat
- Service Charge and Ground Rent - £100 PCM
- Close to Popular Bars and Restaurant of Sale
- Off Road Parking
- Council Tax B
- Quiet Location Off Wardle Road
- Close to Metrolink and Sale Town Centre
- Walking Distance to Worthington Park
- Private Entrance to the Flat
- NO CHAIN

A characterful one bedroom ground floor flat situated on a quiet cul-de-sac in the popular Wardle Road residential area. The flat benefits from its own private entrance on ground floor level and has been finished to a good standard throughout whilst retaining many period features. The internal accommodation comprises: Entrance hallway, bay fronted lounge open to kitchen, large double bedroom and bathroom. The property has ample storage space and off road parking.

Offers Over £160,000



Lease Details

Entrance Hall

Lounge 15'3" (into bay) x 14'0" (4.67m (into bay) x 4.29m)

Kitchen 8'3" x 6'5" (2.54m x 1.98m)

Bedroom 8'3" x 6'5" (2.54m x 1.98m)

Bathroom 9'3" x 6'3" (2.82m x 1.91m)





01619622828

Jordan fishwick

Why take a risk?
Sell Smarter





Floor Plans

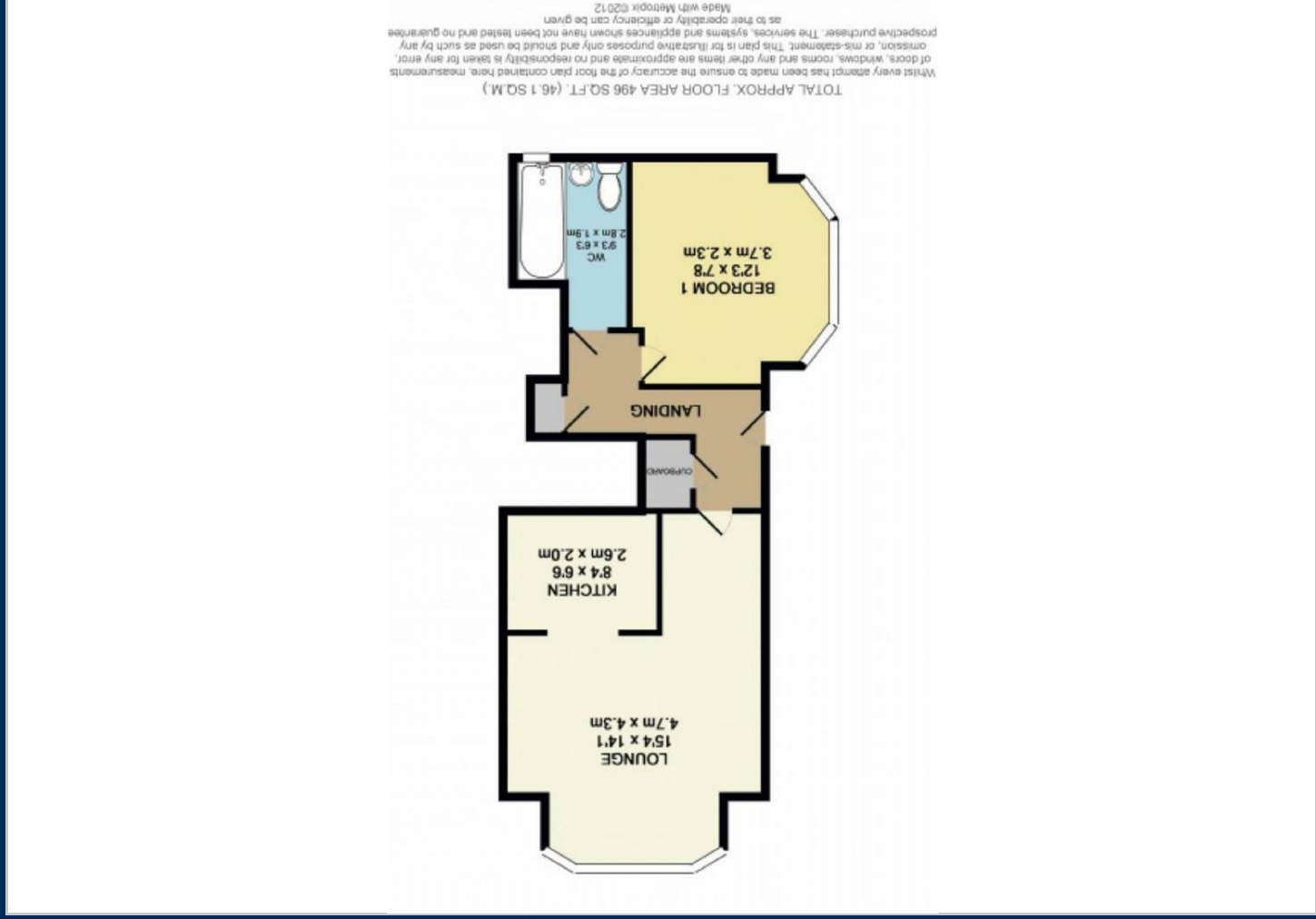

Viewing

Please contact our Sale Office on 0161 962 2828 if you wish to arrange a viewing appointment for this property or require further information.

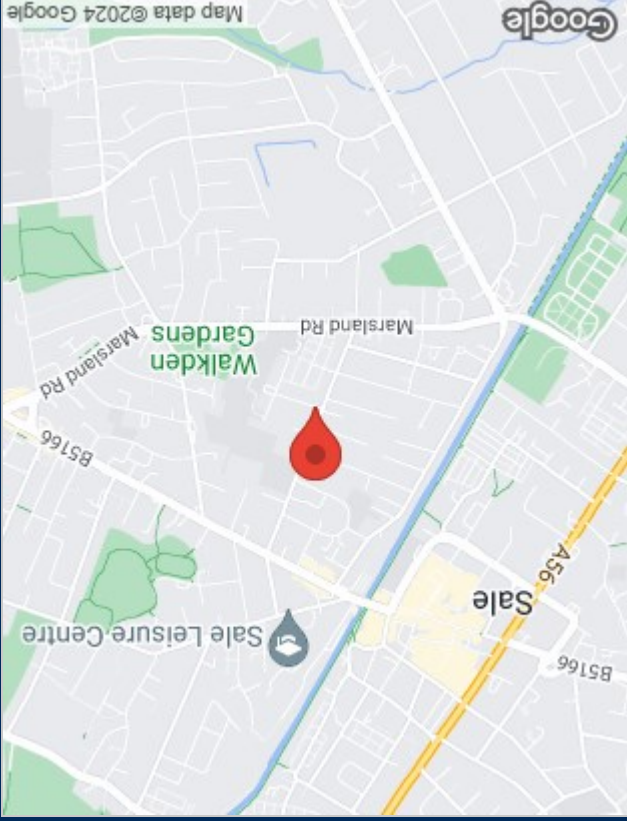

Location Map

Energy Performance Graph

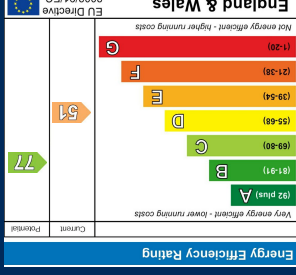

The particulars are set out as a general outline only for the guidance of intended purchasers or lessees, and do not constitute, any part of a contract. Purchasers should satisfy themselves of this prior to purchasing. The particular condition or otherwise nor that any of the services, appliances, equipment or facilities are in good working order. Purchasers should satisfy themselves of this prior to purchasing.