



*jordan fishwick*

60 Park Road, SK9 5BT  
PCM £1,200 PCM



## Park Road WILMSLOW SK9 5BT

£1,200 PCM



### AVAILABLE NOW PART FURNISHED - VIEWING RECOMMENDED

Located on this popular road only minutes from Wilmslow town centre and the train station and in the catchment area for popular local schools is this two bedroom mid terrace.

Benefitting from off road parking and rear garden overlooking the Carnival Fields.

Entrance porch, lounge with feature fire place, dining kitchen with washing machine, dryer, fridge freezer, gas hob and electric oven and door to rear garden.

To the first floor large double bedroom, small double / large single bedroom with fitted wardrobes, bathroom with shower over bath.

Contact Wilmslow 01625 536300 £1200.00pcm



- TWO BEDROOMS
- OFF ROAD PARKING
- WALKING DISTANCE OF STATION AND TOWN CENTRE
- POPULAR LOCATION
- ENCLOSED REAR GARDEN
- COUNCIL TAX C



Energy Efficiency Rating		
	Current	Potential
Very energy efficient - lower running costs		
(92 plus) <b>A</b>		
(81-91) <b>B</b>		
(69-80) <b>C</b>		
(55-68) <b>D</b>		
(39-54) <b>E</b>		
(21-38) <b>F</b>		
(1-20) <b>G</b>		
Not energy efficient - higher running costs		
	<b>67</b>	<b>72</b>
<b>England &amp; Wales</b>	EU Directive 2002/91/EC 	



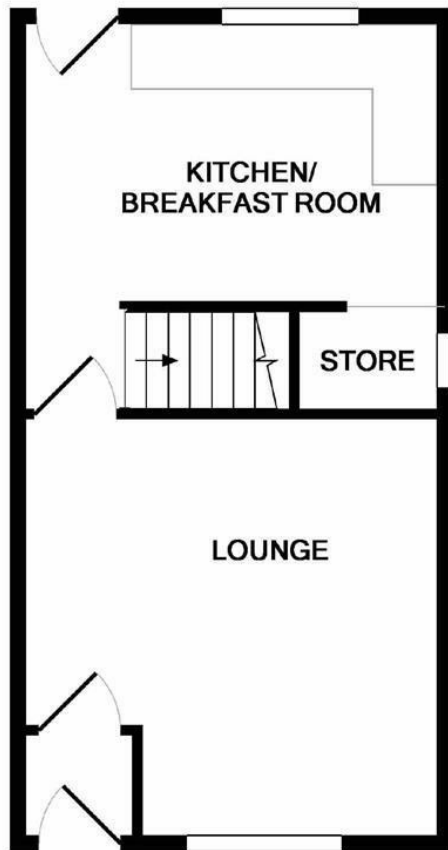

GROUND FLOOR

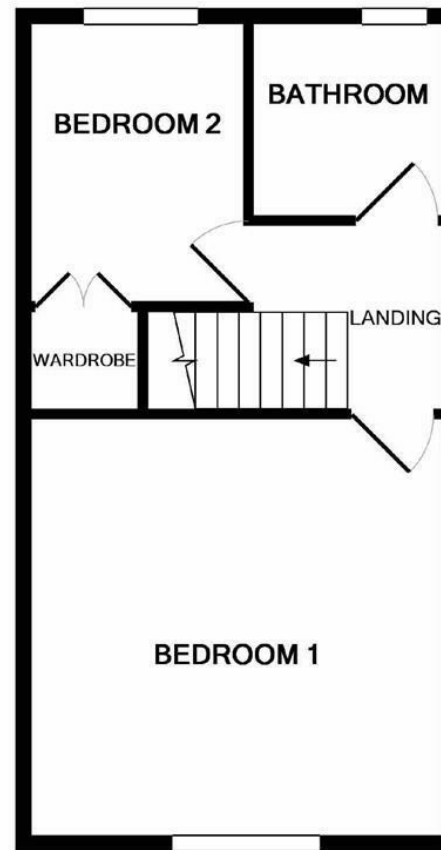

1ST FLOOR

Whilst every attempt has been made to ensure the accuracy of the floor plan contained here, measurements of doors, windows, rooms and any other items are approximate and no responsibility is taken for any error, omission, or mis-statement. This plan is for illustrative purposes only and should be used as such by any prospective purchaser. The services, systems and appliances shown have not been tested and no guarantee as to their operability or efficiency can be given  
 Made with Metropix ©2019



These particulars are believed to be accurate but they are not guaranteed and do not form a contract. Neither Jordan Fishwick nor the vendor or lessor accept any responsibility in respect of these particulars, which are not intended to be statements or representations of fact and any intending purchaser or lessee must satisfy himself by inspection or otherwise as to the correctness of each of the statements contained in these particulars. Any floorplans on this brochure are for illustrative purposes only and are not necessarily to scale.

Offices at: Chorlton, Didsbury, Disley, Hale, Glossop, Macclesfield, Manchester Deansgate, Manchester Whitworth Street, New Mills, Sale, Wilmslow and Withington

01625 536300

wilmslow@jordanfishwick.co.uk  
 www.jordanfishwick.co.uk