



*jordan fishwick*

Buxton Old Road Disley Stockport





**Buxton Old Road Disley Stockport  
SK12 2BB**

**£250,000**



### The Property

**\*\*\*STUNNING HOME\*\*\*** Renovated in recent years from top to bottom and superbly maintained, a fabulous, brick built semi-detached cottage in the heart of Disley Village. Ideal for all the local amenities combined with spacious accommodation make this the perfect home for many buyers. Guaranteed to impress and comprising: living room with dual aspect window overlooking Fountain Square, high quality fitted dining kitchen, utility porch, two generous first floor bedrooms and a bathroom with white suite. Double glazing, gas central heating and enclosed Stone Flagged garden. Viewing Essential.





- Ideal Position in the Centre of Disley Village
- High Quality Finish Throughout
- Stone Paved Rear Garden
- Overlooking Fountain Square
- Double Glazing and Gas Central Heating
- Semi-Detached Home
- Two Generous Bedrooms
- Perfect For The First Time Buyer

**Postcode** SK12 2BB

**EPC Rating** D

**Local Authority** Cheshire East

**Council Tax** B

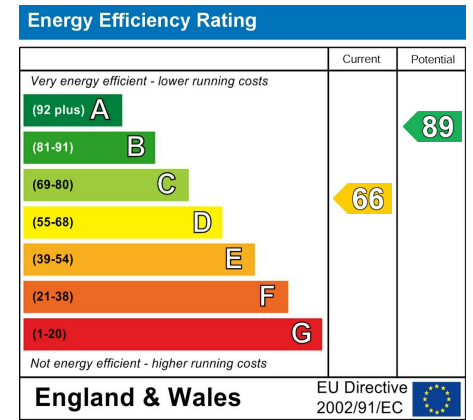

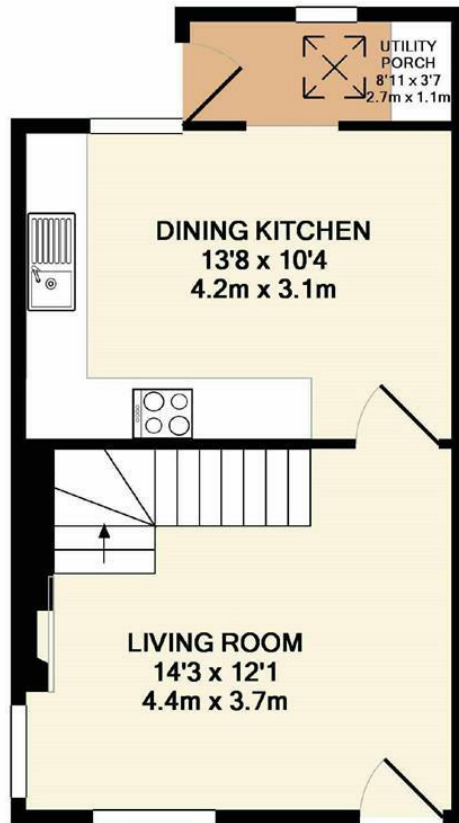

GROUND FLOOR

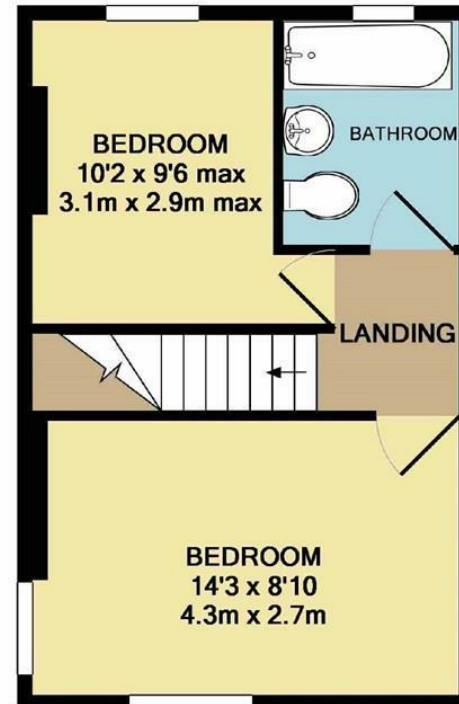

1ST FLOOR

Whilst every attempt has been made to ensure the accuracy of the floor plan contained here, measurements of doors, windows, rooms and any other items are approximate and no responsibility is taken for any error, omission, or mis-statement. This plan is for illustrative purposes only and should be used as such by any prospective purchaser. The services, systems and appliances shown have not been tested and no guarantee as to their operability or efficiency can be given.  
 Made with Metropix ©2019



These particulars are believed to be accurate but they are not guaranteed and do not form a contract. Neither Jordan Fishwick nor the vendor or lessor accept any responsibility in respect of these particulars, which are not intended to be statements or representations of fact and any intending purchaser or lessee must satisfy himself by inspection or otherwise as to the correctness of each of the statements contained in these particulars. Any floorplans on this brochure are for illustrative purposes only and are not necessarily to scale.

Offices at: Chorlton, Didsbury, Disley, Hale, Glossop, Macclesfield, Manchester Deansgate, Manchester Whitworth Street, New Mills, Sale, Wilmslow and Withington

14 Market Street, Disley, Cheshire, SK12 2AA

01663 76 78 78

disley@jordanfishwick.co.uk

www.jordanfishwick.co.uk