

Whilst every attempt has been made to ensure the accuracy of the floorplan contained here, measurements of doors, windows, rooms and any other items are approximate and no responsibility is taken for any error, omission or mis-statement. This plan is for illustrative purposes only and should be used as such by any prospective purchaser. The services, systems and appliances shown have not been tested and no guarantee as to their operability or efficiency can be given.

Made with Metropix ©2023

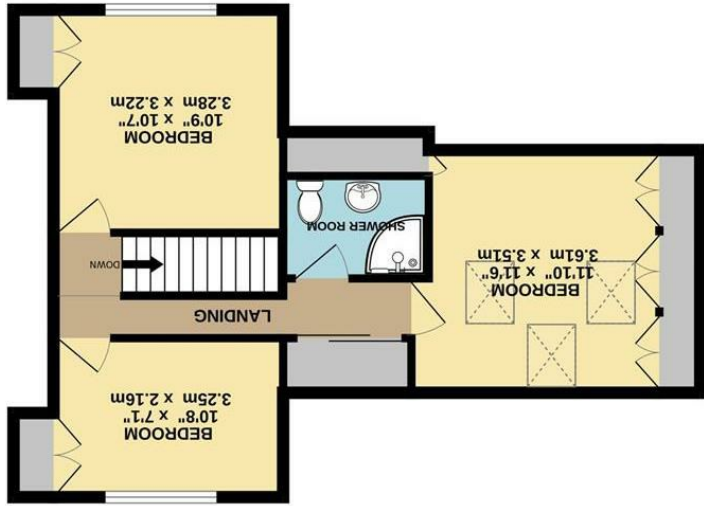

1ST FLOOR



GROUND FLOOR



11 Hartington Road, High Lane,
Stockport, SK6 8BY

£475,000



The Property

Beautifully presented and occupying a prime position within a sought after area in High Lane, a stunning three/four bedroom detached dormer bungalow. Spacious versatile accommodation and immaculate manicured private gardens are sure to appeal. Offered for sale with no onward chain and comprising: entrance hall, living room with French doors onto the garden, re-fitted dining kitchen, separate sitting room/bedroom, contemporary bathroom, three first floor bedrooms and second shower room. Attached garage with electric roller door, utility room, large driveway, pvc double glazing and gas central heating. Viewing essential.

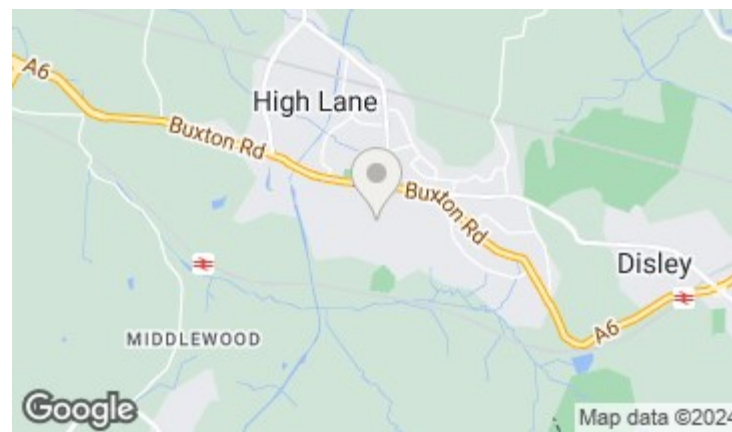

- Immaculate Detached Dormer Bungalow
- Three/Four Bedrooms
- Large Enclosed Beautiful Gardens
- Sought After Location
- Convenient For High Lane Amenities
- Spacious And Versatile
- Attached Garage and Driveway
- Contemporary Bathroom and Shower Room
- No Chain

Postcode - SK6 8BY
EPC Rating - C
Local Authority - Stockport
Council Tax - E

