



Apt 2 Mount Pleasant, St. Marys Road, Glossop, Derbyshire, SK13 8AD

**** 50% OWNERSHIP **** Within the heart of Glossop and the St James Conservation Area, forming part of a sympathetically converted church and hall, this ground floor apartment will appeal to any single occupier or couple looking to get a foot on the property ladder. With double glazing and gas central heating the apartment briefly comprises of an entrance hall, open plan living room and kitchen with oven and hob, a double bedroom with fitted furniture and a bathroom with shower. Energy Rating C

£55,000

Viewing arrangements

Viewing strictly by appointment through the agent

44 High Street West, Glossop, Derbyshire, SK13 8BH 01457 858888

Directions

From our office on High Street West head in the direction of the central traffic lights at Norfolk Square and turn right into Market Street. This changes into Phillip Howard Road and Mount Pleasant can be found at the top crossroads.

GROUND FLOOR

Main Entrance

Private Entrance Hall

Intercom entry phone, central heating radiator and doors leading off to:

Living Room/Kitchen

14'8" x 13'2" (plus recess)

Double glazed window, two central heating radiators, fitted kitchen units including base cupboards and drawers, plumbing for an automatic washing machine, built-in electric oven, work tops over with an inset single drainer stainless steel one and a half bowl sink and mixer tap, gas hob with filter hood over, matching wall cupboards, storage cupboard and cupboard housing the Worcester gas fired central heating boiler.

Bedroom

12'4" x 8'10" (less robes & plus rec's)

Fitted wardrobes, chest of drawers, bedside drawers and

over bed cupboards, two double glazed windows and central heating radiator.

Bathroom

A white suite including a panelled bath with shower over and shower screen, pedestal wash hand basin and close coupled wc, central heating radiator.

Shared Ownership

The property is subject to a monthly service charge and rent on the other 50% details available on request

It is understood that an additional share in the property can be bought with agreement with Johnnie Johnson Housing.

All interested parties will be required to apply to Johnnie Johnson for approval

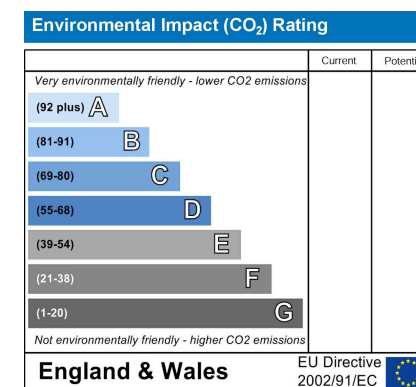
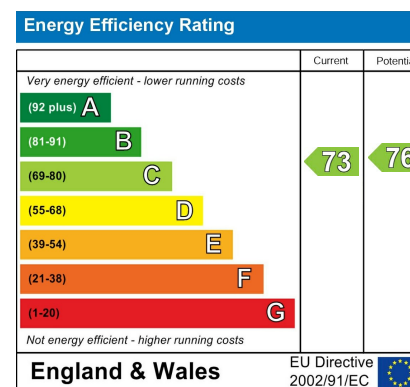



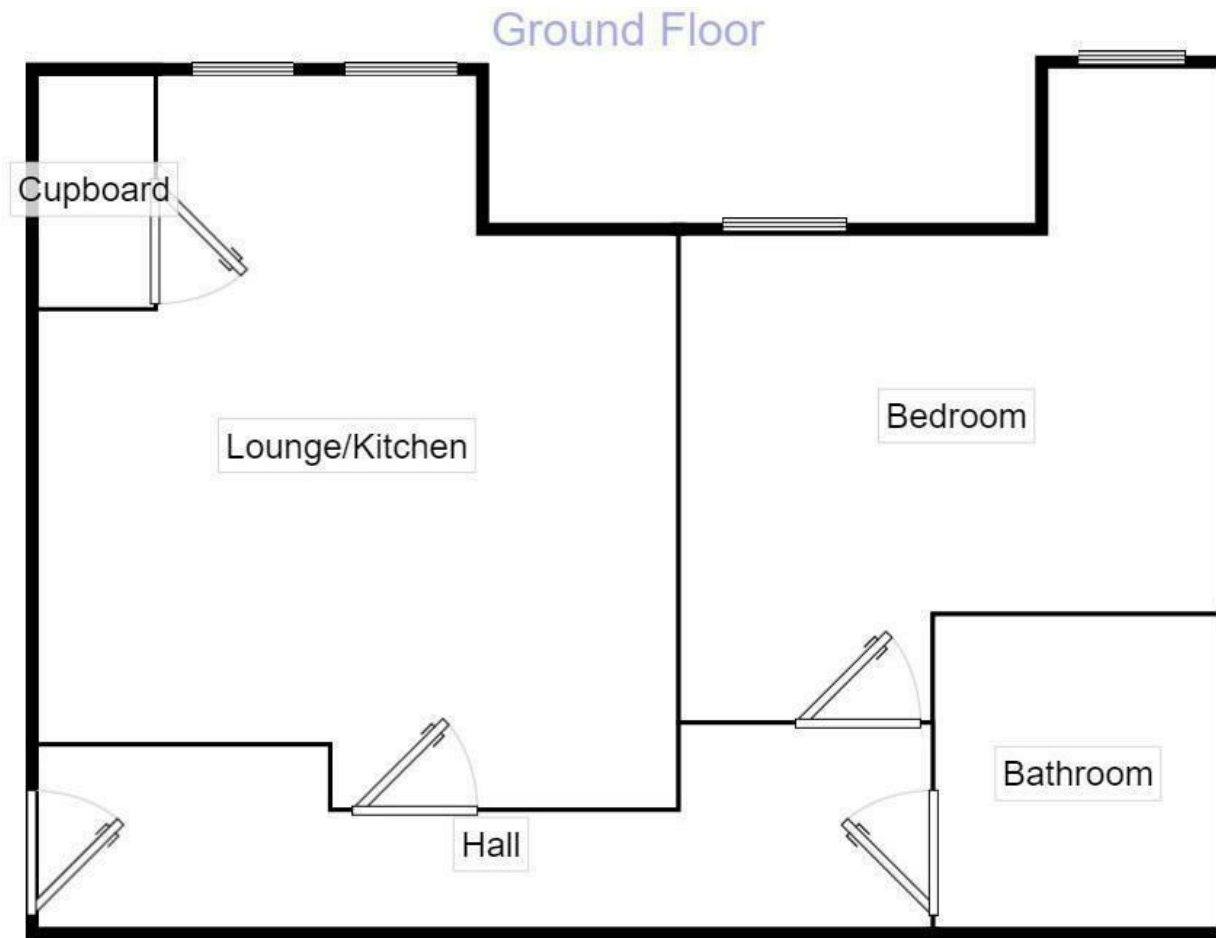

Measurements are approximate. Not to scale. For illustrative purposes only.



These particulars are believed to be accurate but they are not guaranteed and do not form a contract. Neither Jordan Fishwick nor the vendor or lessor accept any responsibility in respect of these particulars, which are not intended to be statements or representations of fact and any intending purchaser or lessee must satisfy himself by inspection or otherwise as to the correctness of each of the statements contained in these particulars. Any floorplans on this brochure are for illustrative purposes only and are not necessarily to scale.

Offices at: Chorlton, Didsbury, Disley, Hale, Glossop, Macclesfield, Manchester Deansgate, Manchester Whitworth Street, New Mills, Sale, Wilmslow and Withington

44 High Street West, Glossop, Derbyshire, SK13 8BH

01457 858888

glossop@jordanfishwick.co.uk
www.jordanfishwick.co.uk

