



jordan fishwick

FALLOWFIELD
Horton Road



Horton Road, Fallowfield, M14 7QB

£220,000



The Property

A spacious, well presented garden fronted 2 double bedroom terrace property, suitable for a number of buyers including first time buyer or professional couple, well placed for Manchester City centre with excellent transport links in a quiet location. The accommodation comprises: Large light and spacious open plan living area with lounge and dining areas with exposed brick chimney breasts, stripped floor opening to the fitted kitchen with white fronted cupboards with wooden effect work tops over, tiled flooring and built in appliances. To the first floor: Master bedroom with twin windows to the front, additional double bedrooms and a modern bathroom fitted with a white suite. Gas central heating and double glazing are both installed. There is a south facing courtyard garden to the rear of the property. Viewing is recommended. No chain.

Directions

M14 7QB



- A light and spacious terrace property
- Open plan lounge, dining room and kitchen
- Two double bedrooms
- South facing courtyard garden to rear
- Double glazing & gas central heating
- Excellent location close to amenities
- No chain

Postcode - M14 7QB

EPC Rating - D

Floor Area - 713.00 sq ft

Local Authority - Manchester City Council

Council Tax - A



GROUND FLOOR
363 sq.ft. (33.7 sq.m.) approx.

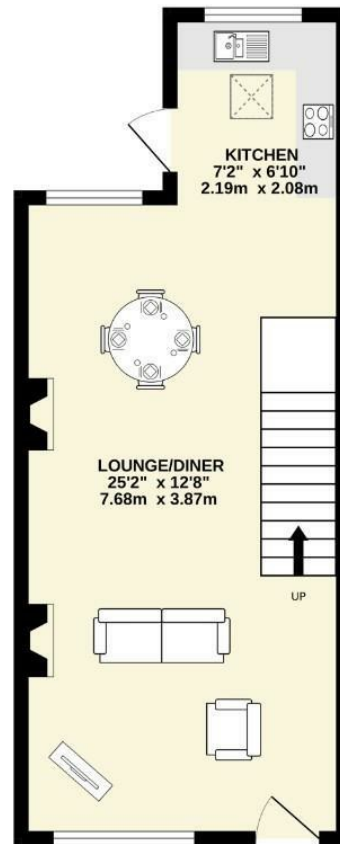

1ST FLOOR
350 sq.ft. (32.5 sq.m.) approx.

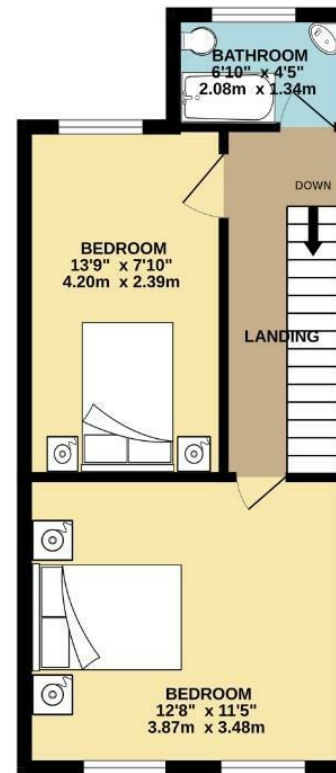

TOTAL FLOOR AREA: 713 sq.ft. (66.3 sq.m.) approx.
Measurements are approximate. Not to scale. Illustrative purposes only.
Made with Metropix ©2023



These particulars are believed to be accurate but they are not guaranteed and do not form a contract. Neither Jordan Fishwick nor the vendor or lessor accept any responsibility in respect of these particulars, which are not intended to be statements or representations of fact and any intending purchaser or lessee must satisfy himself by inspection or otherwise as to the correctness of each of the statements contained in these particulars. Any floorplans on this brochure are for illustrative purposes only and are not necessarily to scale.

Offices also at: Wilmslow, Macclesfield, Hale, Sale, Chorlton, Glossop, Manchester & Salford

757-759 Wilmslow Road, Didsbury Village, Manchester

0161 445 4480

didsbury@jordanfishwick.co.uk
www.jordanfishwick.co.uk