



Jordan fishwick

Eaves Knoll Road New Mills High Peak

Eaves Knoll Road New Mills High Peak SK22 3DN

Price £225,000



The Property

Occupying an enviable position in a sought after area close to High Lea Park, a garden fronted stone mid terrace property. With two bedrooms and large dining kitchen offering scope for further cosmetic improvement and also benefitting from no onward chain. In brief the property comprises; living room and dining kitchen with exposed brickwork to the ground floor, whilst to the first floor there are two bedrooms and bathroom with white suite. There is a walled garden to the front and an enclosed rear garden with lawn and raised flower beds.

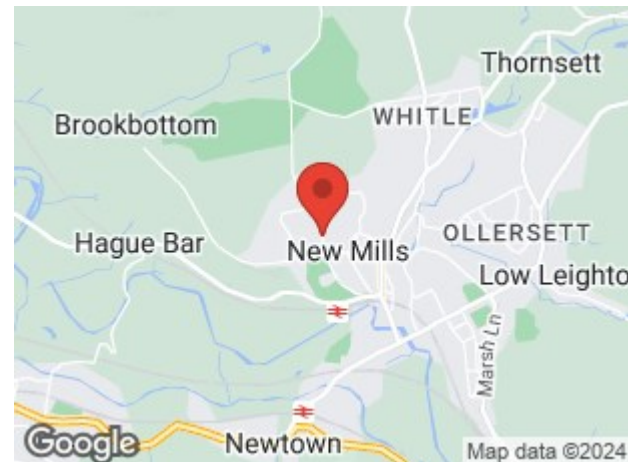

- Two Bedroom Mid Terrace Property
- Enclosed Private Rear Garden
- Large Dining Kitchen with Exposed Brickwork
- Popular Area Close to High Lea Park and New Mills Centre
- Scope For Further Cosmetic Improvement
- No Onward Chain
- Upvc Double Glazing and Gas Central Heating
- Garden Fronted

Postcode SK22 3DN

EPC Rating D

Local Authority High Peak Borough Council

Council Tax B

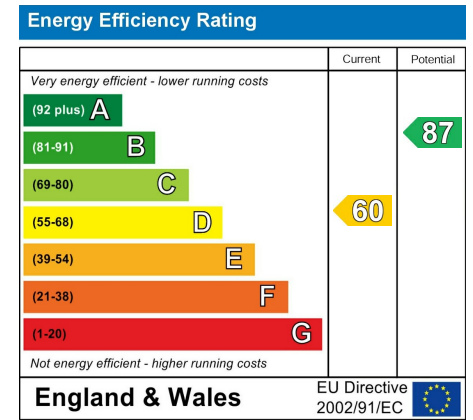

GROUND FLOOR
361 sq.ft. (33.5 sq.m.) approx.

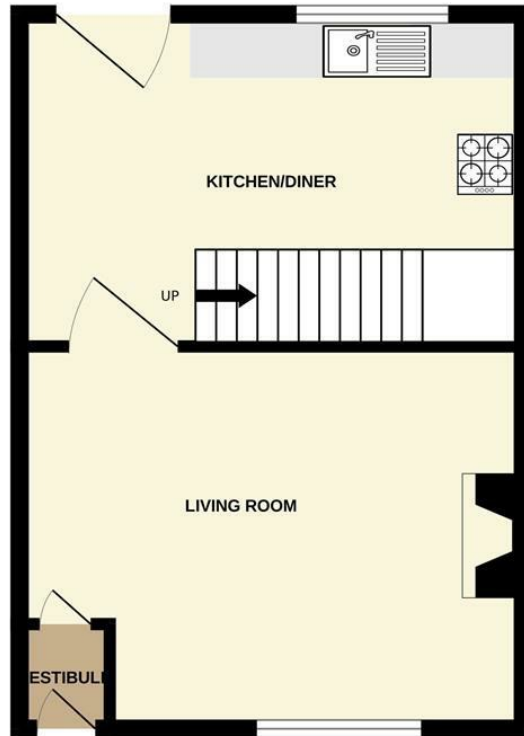

1ST FLOOR
367 sq.ft. (34.1 sq.m.) approx.



TOTAL FLOOR AREA : 728 sq.ft. (67.7 sq.m.) approx.

Whilst every attempt has been made to ensure the accuracy of the floorplan contained here, measurements of doors, windows, rooms and any other items are approximate and no responsibility is taken for any error, omission or mis-statement. This plan is for illustrative purposes only and should be used as such by any prospective purchaser. The services, systems and appliances shown have not been tested and no guarantee as to their operability or efficiency can be given.
Made with Metropix ©2023



These particulars are believed to be accurate but they are not guaranteed and do not form a contract. Neither Jordan Fishwick nor the vendor or lessor accept any responsibility in respect of these particulars, which are not intended to be statements or representations of fact and any intending purchaser or lessee must satisfy himself by inspection or otherwise as to the correctness of each of the statements contained in these particulars. Any floorplans on this brochure are for illustrative purposes only and are not necessarily to scale.

Offices at: Chorlton, Didsbury, Disley, Hale, Glossop, Macclesfield, Manchester Deansgate, Manchester Whitworth Street, New Mills, Sale, Wilmslow and Withington

2 Union Road, New Mills, High Peak, Derbyshire, SK22 3ES

01663 767878

newmills@jordanfishwick.co.uk

www.jordanfishwick.co.uk