



Jordan fishwick

NORTHENDEN
Coppice Drive



Coppice Drive, Northenden, M22 4DT

Guide Price £180,000



The Property

This property is for sale by Modern Method of Auction powered by iamsold LTD - Starting Bid £180,000+ Reservation Fee

Located in the corner of a SMALL CUL-DE-SAC, this appealing end terrace home offers SUPERB POTENTIAL and the chance to create a LOVELY FAMILY HOME, with LARGE GARDENS TO THREE SIDES and the POSSIBILITY TO EXTEND, subject to the required approval. The living space includes two double bedrooms, a spacious living room, fitted kitchen, downstairs bathroom and a separate WC on both the ground and first floors. This chain free property is also perfectly placed for access to Northenden Village, the M56 / M60 motorway network, Manchester city centre and the airport. *No onward chain*

Directions

M22 4DT



- For Sale by Modern Auction
- Subject to Reserve Price & Reservation Fee
- Ideal cul-de-sac location
- Close to Northenden Village
- Two double bedrooms
- Generous living room
- Fitted kitchen
- Downstairs bathroom
- Possibility to extend (subject to PP)
- No onward chain

Postcode - M22 4DT

EPC Rating - D

Floor Area - 801.00 sq ft

Local Authority - Manchester City Council

Council Tax - B



GROUND FLOOR
402 sq.ft. (37.3 sq.m.) approx.

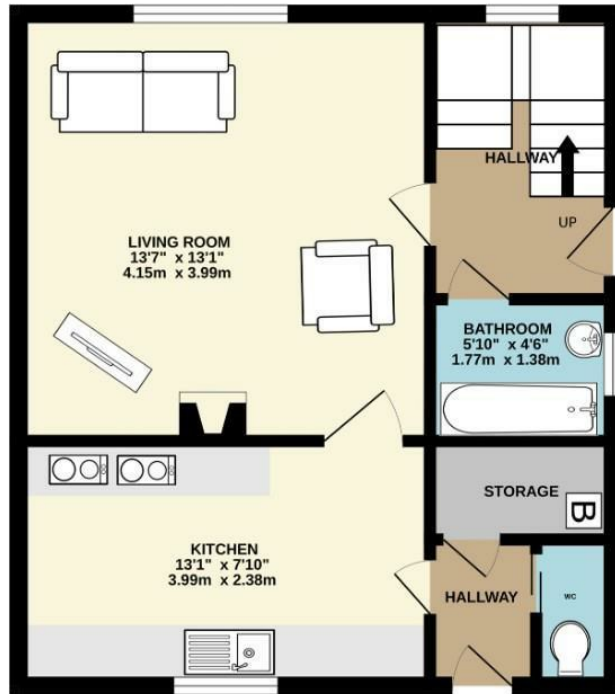

1ST FLOOR
399 sq.ft. (37.1 sq.m.) approx.

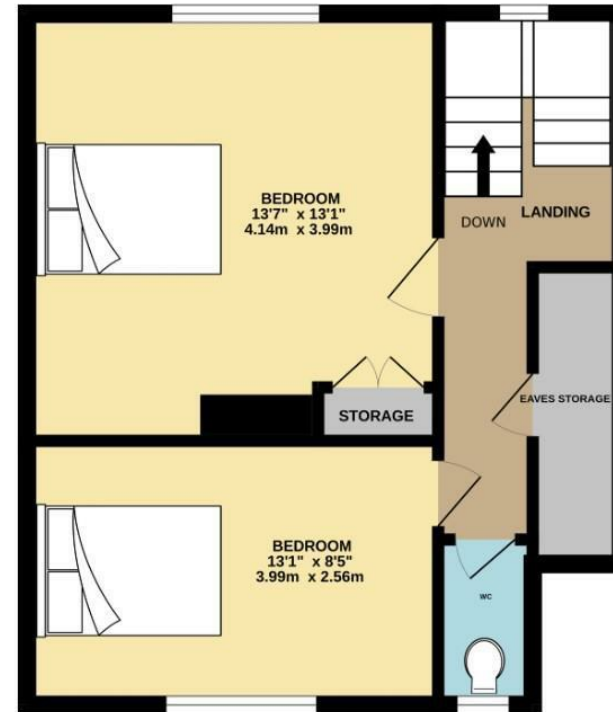

TOTAL FLOOR AREA : 801 sq.ft. (74.4 sq.m.) approx.
Measurements are approximate. Not to scale. Illustrative purposes only
Made with Metropix ©2023



These particulars are believed to be accurate but they are not guaranteed and do not form a contract. Neither Jordan Fishwick nor the vendor or lessor accept any responsibility in respect of these particulars, which are not intended to be statements or representations of fact and any intending purchaser or lessee must satisfy himself by inspection or otherwise as to the correctness of each of the statements contained in these particulars. Any floorplans on this brochure are for illustrative purposes only and are not necessarily to scale.

Offices also at: Wilmslow, Macclesfield, Hale, Sale, Chorlton, Glossop, Manchester & Salford

757-759 Wilmslow Road, Didsbury Village, Manchester

0161 445 4480

didsbury@jordanfishwick.co.uk
www.jordanfishwick.co.uk