



jordan fishwick

Marsh Lane New Mills High Peak



Marsh Lane New Mills High Peak SK22 4PN

Auction Guide £160,000



The Property

** For sale by Modern Method of Auction; Starting Bid Price £160,000 plus Reservation Fee **

Occupying an enviable position within New Mills with views over open countryside, a garden fronted stone built semi-detached home. **FANTASTIC POTENTIAL** and comprising: entrance vestibule, living room, dining room, kitchen, two good sized first floor bedrooms and a bathroom. Pvc double glazing, gardens, detached garage and drive. **NO CHAIN and VIEWING HIGHLY RECOMMENDED.**

This property is for sale by The Great North Property Auction powered by iamsold



- For Sale By Auction - T & C's Apply
- Buyers Fees Apply
- The Modern Method of Auction View Bid & Buy
- In Need of Modernisation
- Highly Regarded Residential Area
- Stone Built Semi Detached Property with Two Good Sized Bedrooms
- Garden Fronted and Off Road Parking
- Lovely Forward Views and Close to Open Countryside

Postcode SK22 4PN

EPC Rating G

Local Authority High Peak Borough Council

Council Tax B

Energy Efficiency Rating		Current	Potential
Very energy efficient - lower running costs			
(92 plus) A			
(81-91) B			84
(69-80) C			
(55-68) D			
(39-54) E			
(21-38) F		12	
(1-20) G			
Not energy efficient - higher running costs			
England & Wales		EU Directive 2002/91/EC 	



GROUND FLOOR

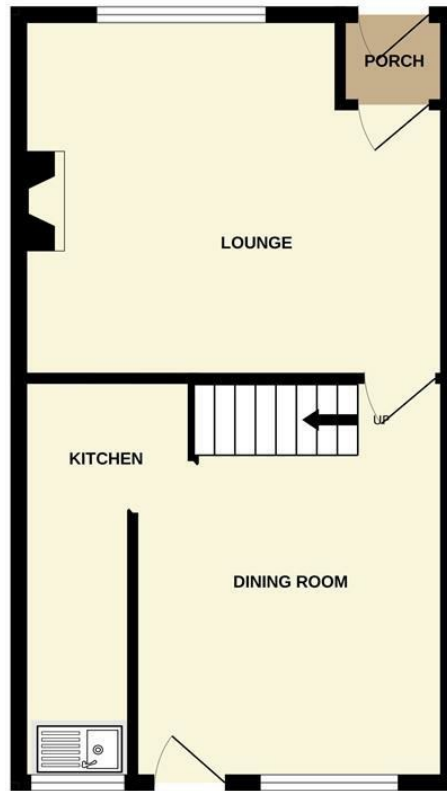

1ST FLOOR

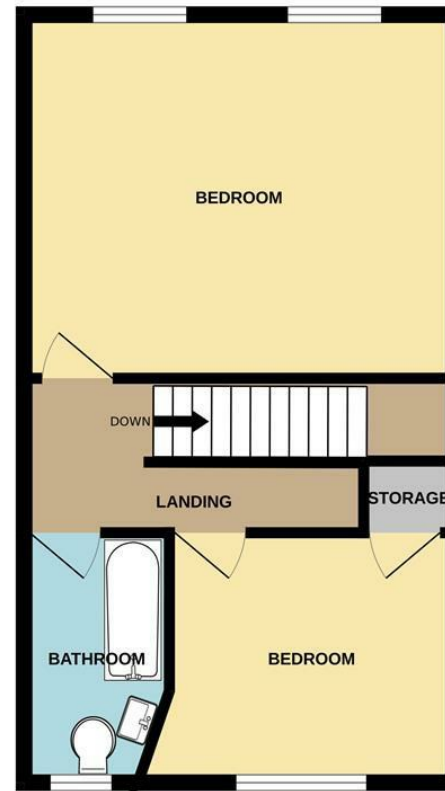

Whilst every attempt has been made to ensure the accuracy of the floorplan contained here, measurements of doors, windows, rooms and any other items are approximate and no responsibility is taken for any error, omission or mis-statement. This plan is for illustrative purposes only and should be used as such by any prospective purchaser. The services, systems and appliances shown have not been tested and no guarantee as to their operability or efficiency can be given.
Made with Metropix ©2023



These particulars are believed to be accurate but they are not guaranteed and do not form a contract. Neither Jordan Fishwick nor the vendor or lessor accept any responsibility in respect of these particulars, which are not intended to be statements or representations of fact and any intending purchaser or lessee must satisfy himself by inspection or otherwise as to the correctness of each of the statements contained in these particulars. Any floorplans on this brochure are for illustrative purposes only and are not necessarily to scale.

Offices at: Chorlton, Didsbury, Disley, Hale, Glossop, Macclesfield, Manchester Deansgate, Manchester Whitworth Street, New Mills, Sale, Wilmslow and Withington

2 Union Road, New Mills, High Peak, Derbyshire, SK22 3ES

newmillsforward@jordanfishwick.co.uk

www.jordanfishwick.co.uk