



*jordan fishwick*

Unicorn House The Village, Prestbury,  
PCM £1,200 PCM



## The Village Macclesfield SK10 4DG

£1,200 PCM



AVAILABLE NOW FURNISHED - VIEWING RECOMMENDED

Prestbury Village is an extremely popular location and this second floor apartment is located next to the church in the heart of the village. Forming part of a listed building and only a stones throw for all the local bars and restaurants and has the added benefit of off road parking to the rear.

With a modern dining kitchen and bathroom along with a good sized living room and two double bedrooms this attractive property makes an ideal base for the professional.

Communal light and airy entrance hall with stairs to the apartment, private entrance hall with intercom, modern dining kitchen with electric hob and oven, washing machine and dryer, dishwasher and fridge freezer, inner hallway leading to bathroom with shower over bath, double bedroom, lounge with window overlooking the main street, further double bedrooms.

Allocated off road parking for 1 car.

Contact Wilmslow 01625 536300 £1200.00pcm





- TWO DOUBLE BEDROOMS
- CENTRAL VILLAGE LOCATION
- MODERN KITCHEN AND BATHROOM
- OFF ROAD PARKING TO REAR
- COUNCIL TAX C



## GROUND FLOOR

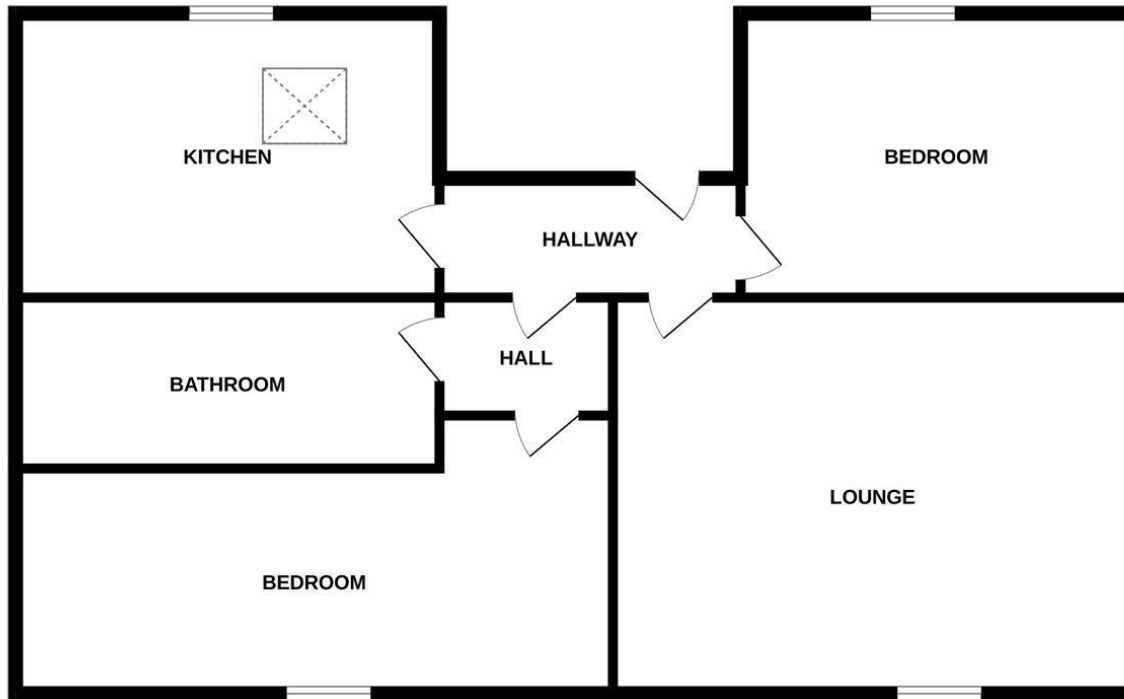

Measurements are approximate. Not to scale. Illustrative purposes only.  
Made with Metropix ©2024



These particulars are believed to be accurate but they are not guaranteed and do not form a contract. Neither Jordan Fishwick nor the vendor or lessor accept any responsibility in respect of these particulars, which are not intended to be statements or representations of fact and any intending purchaser or lessee must satisfy himself by inspection or otherwise as to the correctness of each of the statements contained in these particulars. Any floorplans on this brochure are for illustrative purposes only and are not necessarily to scale.

Offices at: Chorlton, Didsbury, Disley, Hale, Glossop, Macclesfield, Manchester Deansgate, Manchester Whitworth Street, New Mills, Sale, Wilmslow and Withington

01625 536300

wilmslow@jordanfishwick.co.uk  
www.jordanfishwick.co.uk